

FCC Statement

Changes or modifications not expressly approved by the party responsible for compliance could void the user's authority to operate the equipment.

This equipment has been tested and found to comply with the limits for a Class B digital device, pursuant to Part 15 of the FCC Rules. These limits are designed to provide reasonable protection against harmful interference in a residential installation. This equipment generates uses and can radiate radio frequency energy and, if not installed and used in accordance with the instructions, may cause harmful interference to radio communications. However, there is no guarantee that interference will not occur in a particular installation. If this equipment does cause harmful interference to radio or television reception, which can be determined by turning the equipment off and on, the user is encouraged to try to correct the interference by one or more of the following measures:

- Reorient or relocate the receiving antenna.
- Increase the separation between the equipment and receiver.
- Connect the equipment into an outlet on a circuit different from that to which the receiver is connected.
- Consult the dealer or an experienced radio/TV technician for help

This device complies with part 15 of the FCC rules. Operation is subject to the following two conditions (1) this device may not cause harmful interference, and (2) this device must accept any interference received, including interference that may cause undesired operation.

MINUSWIRE

www.minuswire.com

Support contact:

E-mail: support@minuswire.com

MANUFACTURER

Dongguan Kantsang Electroacoustic Technology Co., Ltd.

Address: No.8, Lu Yi Yi Road, Tangxia, Dongguan, China

 Bluetooth®



MADE IN CHINA

FCC ID: PAZMW-1100PROX

FCC ID: PAZMW-1100PROX-R



MW-1100ProX

MINUSWIRE

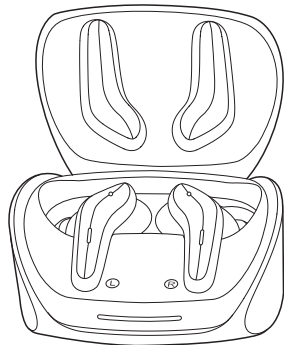

MODEL: MW-1100ProX
ACTIVE NOISECANCELLING TRUE
WIRELESS STEREO EARBUDS

User Guide

PACKAGE CONTENTS (Fig. 1)

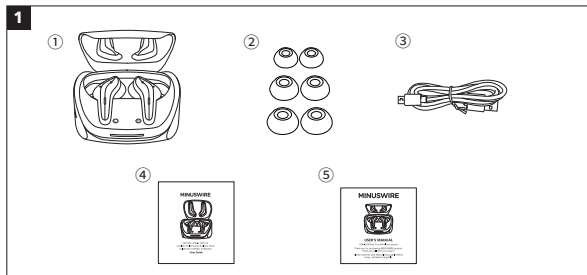

EN

- ① Active Noise-Cancelling True Wireless Stereo Earbuds (MW-1100ProX)
- ② 6 x Ear Tips (two are equipped on the earbuds)
- ③ 1 x USB Charging Cable
- ④ 1 x User Manual
- ⑤ 1 x Quick Start Guide

PRODUCT DIAGRAM (Fig. 2)

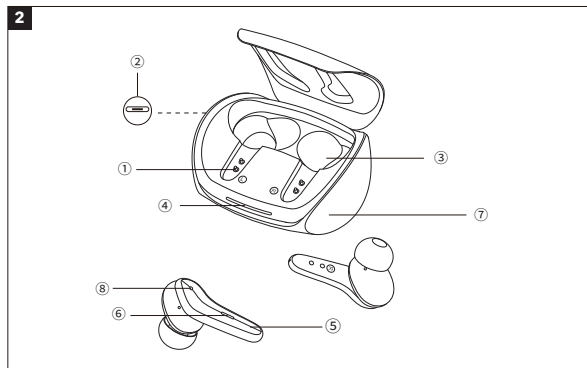

EN

Product Diagram

- ① Charging Contacts
- ② USB-C Charging Port
- ③ Charging Slot
- ④ Charging Indicators
- ⑤ Touch Sensor area
- ⑥ LED Indicator
- ⑦ Charging Case
- ⑧ Microphone

IMPORTANT SAFETY INSTRUCTIONS

Please read the instructions thoroughly before using this product and retain it for future reference.

Hearing Safety

- Do not wear earbuds with high volume for a long time to avoid damaging your hearing.
- Set the earbuds to low volume before you put them on, then increase the volume gradually as per your preference.
- Do not set volume too high to stay aware of your surroundings.
- Please refer to local laws and regulations if you want to answer phone calls via this device during driving.
- For your safety, avoid distraction from music or phone calls when you are driving or doing other activities with potential dangers.

Warning: Please set the volume to proper level to avoid hearing damages.

Caution

- Do not expose this product to high temperatures.
- Do not immerse the earbuds into water or expose them to humidity for a long time.
- Do not clean the product with detergent containing alcohol, ammonia, benzene or abrasives.
- Avoid dropping.
- Place the earbuds back into the charging case when not in use and keep it away from children and pets to avoid choking hazard.
- Unauthorized disassembly of any parts of this product is forbidden, which

- may cause fire hazard, warranty voidance, and/or property loss.
- Close attention is needed when using near children.
- Keep the charging case away from water, rain or any other liquid.
- Don't use the product in thunderstorm to avoid malfunction or electric shock.
- Always ask a professional technician or authorized personnel for repair.



This product contains lithium battery. Never expose it to excessive heat such as direct sunlight or fire to avoid explosion.

HOW TO WEAR

Choose the Right Tips (Fig. 3)

Ear tips with different sizes are included in the package, try all sizes and choose the ones fitting you best.

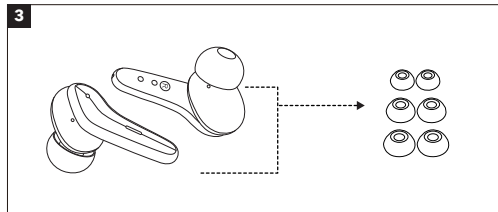

Wear the Earbuds (Fig. 4)

Please wear the earbuds as shown below.

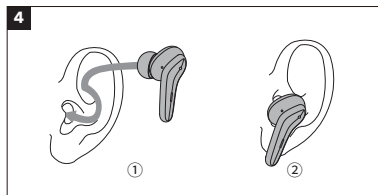

Pictures only for reference.

Bluetooth Caution

- When the device is connected wirelessly to another device, place the two devices close to each other to achieve their normal functionalities and avoid possible signal interference.
- When using a wireless connection, make sure there are no obstacles between the two devices. Obstacles including walls and fences may shorten the effective range.

USING YOUR EARBUDS

Charging Charging the Earbuds (Fig. 5) (Fig. 6)

1. Put the earbuds into the charging case as per the L (left) and R (right) marks (Fig. 5).
2. Cover the lid and charging will start automatically (Fig. 6).

03

Note:

- Please fully charge the earbuds when using them for the first time.
- When battery is low, a "Battery Low Please Recharge" voice prompt will be heard (if you are wearing the earbuds). Please charge it in time or the earbuds will turn off automatically around 10 minutes later.
- Charge the earbuds at least once every 3 months when not using for a long time.

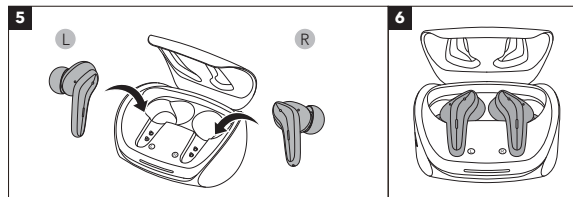

Charging the Charging Case (Fig. 7)

1. Connect the charging port with any USB charging adapter or active computer USB port (Fig. 7).
2. The four step charging bar will light up progressively.

Note: Unplug the charging cable (timely) when fully charged.

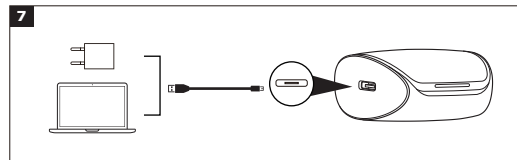

04

Charging (Fig. 8)

Charging the earphones

Earphone light on during charging

100% Full charged, earphone lights go out

Charging the charging box

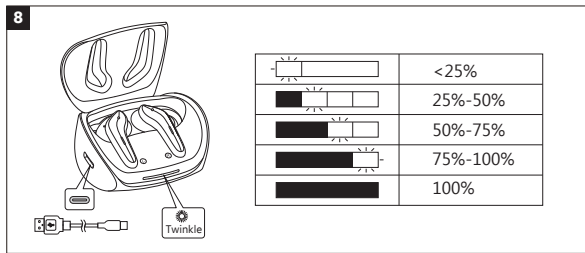

Power On (Fig. 9)

Uncover the lid, the earbuds will power on automatically. The LED indicators on both earbuds will light up red and then blue.

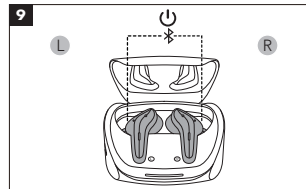

Power Off (Fig. 10)

Put the earbuds into the charging case and cover the lid. The earbuds will turn off automatically.

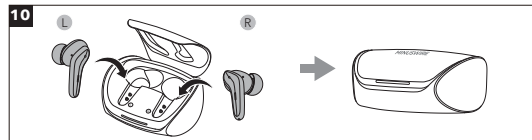

- You can use one earbud or both earbuds as per your preference. Please refer to the corresponding pairing instructions.
- Before pairing, please turn off other Bluetooth devices and place the device to be connected close to the earbuds.
- When the earbuds are disconnected from your device for more than 5 minutes, they will turn off automatically.

Pairing (Fig. 11)

If keep the lid open but there is no Bluetooth connection is made for 5 minutes. The earbuds will turn off automatically.

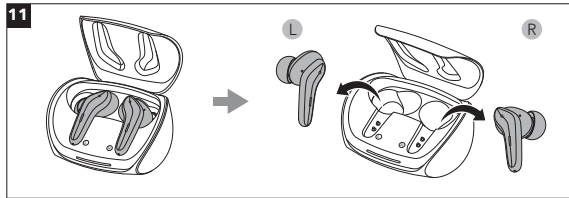

Couple Earbuds Mode

1. Uncover the lid and the earbuds will turn on automatically. They will connect with each other. Once connected, The LED indicator on Right earbud will flash blue and red alternatively. The LED indicator on Left earbud will flash blue intermittently indicating the earbuds are in pairing mode now.
2. Turn on the Bluetooth function on your device and search for nearby devices. Find "MW-1100ProX" in the searching results, tap on the name to connect.
3. Once connected, the LED indicators on both earbuds be turned blue intermittently.
4. Take out both earbuds from the charging case. The LED indicators on both earbuds be turned off.

Note:

- If the earbuds failed to pair with each other, please disconnect the Bluetooth connection with your device, put them back into the charging case, close the lid then open it and take out the earbuds to pair again.
- It is not recommended to wear the two earbuds on different people. If needed, please keep the 2 earbuds within 3 meters / 9.8 feet in couple earbuds mode.

Single Earbud Mode

1. Repeat the steps correspond to Couple Earbuds Mode. Take out one earbud from the charging case, and make sure the other one is placed in the charging case.

Note:

If you want to change to couple mode, simply take out the other earbud from the charging case, they will pair with each other automatically.

If you want to swap to another earbud, simply take out the other earbud from the charging case and put the earbud just being used back to charging case.

Note:

If you want to pair the earbuds with another device when you have already paired them with a device, deactivate the Bluetooth function on the paired device or clear "MW-1100ProX" from its Bluetooth list.

OPERATION AND FUNCTIONS

Function	Operation	Voice Prompt from earbuds
Answer Phone Call	Press the touch sensor area on either of the earbuds 1 times	none
Hang up Phone Call	Press the touch sensor area on either of the earbuds 2 times	none
Reject Incoming Call	Long press the touch sensor area on either of the earbuds for 2 seconds	Call Rejected
Previous Track (Not available when use in single earbud mode)	Press the touch sensor area on the left earbud 2 times	none
Next Track (Not available when use in single earbud mode)	Press the touch sensor area on the right earbud 2 times	none
Play / Pause	Press the touch sensor area on either of the earbuds once	none
ANC mode / Ambient mode (Not available when use in single earbud mode)	Long Press the touch sensor area for 2 seconds, (left / right earphone) to toggle between ANC on, Ambient Sound, and ANC off	ANC ON > Ambient Sound > ANC Off
Activate Siri / Google Assistant	When the earbuds are paired with your device successfully, press 3 times the touch sensor area (left / right earphone)	none

CLEANING AND MAINTENANCE

1. Clean the earbuds and the charging case on a regular basis.
 2. Use dry and soft cotton cloth to wipe the unit.
- Note:** Do not insert anything into the product.
3. Keep away from sharp objects to avoid scratches.
 4. Put the unit in a dry and shady place if it is to be idle for a long time.
 5. Do not clean the product with detergent or chemicals.

TROUBLESHOOTING

No.	Problem	Solution
1	Failed to turn on the earbuds	Earbuds low battery, please charge them
2	Failed to charge the earbuds	<ul style="list-style-type: none"> • Place the earbuds into the charging case properly • Make sure the charging case is charged fully
3	Can't charge the charging case	Make sure the charging cable is intact and plugged in properly
4	Can't find "MW-1100ProX" in the Bluetooth device list	<p>The earbuds reconnected with previously paired device automatically:</p> <ul style="list-style-type: none"> • Deactivate the Bluetooth function of previously paired device or clear "MW-1100ProX" from its Bluetooth device list, and then search again

5	Failed to pair the earbuds with your device	<ul style="list-style-type: none"> • Turn on the device and activate its Bluetooth function before pairing • Bring the earbuds into pairing mode as instructed in the "Pairing" section
6	No sound in one of the earbuds in couple earbuds mode	Place both earbuds back to the charging case then take them out, they will pair with each other automatically. If pairing failed, restore them back to the factory settings as instructed in the "Clear Pairing List" section
7	Poor sound quality	<ul style="list-style-type: none"> • Wear the earbuds properly and keep them close to each other • Place the connected device close to the earbuds or remove the obstacles between them • Clear the debris on the earbuds
8	Unstable connection	<ul style="list-style-type: none"> • The effective distance may shorten with obstacles in the way • Turn off other Bluetooth devices to decrease the interference
9	Can't hear the other party during a phone call	Set the volume to higher level
10	The other party can't hear your voice during a phone call	Free the built-in microphone of any covers

11	Noise-Cancelling doesn't work	<ul style="list-style-type: none"> • Make sure use in couple earbud mode. • Wear the earbuds properly and keep them close to each other • Place the connected device close to the earbuds or remove the obstacles between them <p>Clear the debris on the earbuds</p>
12	Touch sensor area of the earbuds is unresponsive	Place the two earbuds into the charging case and cover the lid, disconnect the Bluetooth connection. Uncover the lid to turn on the earbuds and pair again

WARRANTY AND SERVICE

If any problems occur, please contact the Minuswire Customer Care Centre in your country via the contact information listed in this User Guide.