



Wireless Controller for N-SL

Model NO.SW001

USER GUIDE

♥ Product Description

This product is a wireless Bluetooth gamepad, which belongs to the wireless blue control gamepad (using wireless Bluetooth technology). It can be remotely controlled and easy to operate. It can be used for the Switch console. It also supports PC x-input PC games.

♥ Product Parameter

Voltage: DC 3.6-4.2V

Working Current: <30mA

Sleep Current: 0uA

Battery Capacity: 550mAh

Use time: 6-8 hours

Charging time: 2-3 hours

Vibration Current: 90-120mA

Charging Current: >350mA

USB length: 70 cm/2.30 ft

Bluetooth Transmission Distance <8m

♥ Button Instructions

The gamepad consists of 19 digital buttons (UP, DOWN, LEFT, RIGHT, A, B, X, Y, L1, R1, L2, R2, L3, R3, -, +, TURBO, HOME, screenshot); two analog 3D joystick composition.

L-stick & R-stick : The new 360-degree design makes operating the joystick easier and more convenient.

The indicator lights flash quickly, indicating the pairing; if the blue light is always on then the pairing is complete.

- D-pad button *4: Up, Down, Left, Right.
- Action button *4: A, B, X, Y.
- Menu button:
 - "H"-HOME;
 - "T"-TURBO;
 - "O"-Capture;
 - "+"-Menu selection +;
 - "-"-Menu selection-.
- Function keys *4 : L/R/ZL/ZR

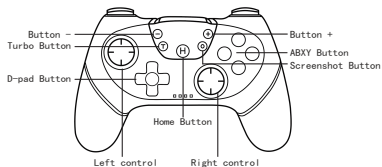
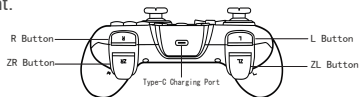

Pairing and Connecting

• Bluetooth connection in console mode:

Step 1: Turn on the console, click the System settings menu button on the main page interface (Figure ①), enter the next menu option, click the Airplane Mode option (Figure ②), and then click the Controller Connection (Bluetooth) (Figure ③) option Turn on its Bluetooth function (Figure ④).

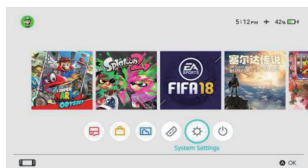

①

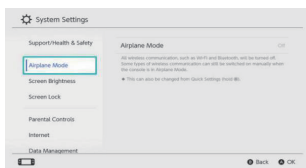

②

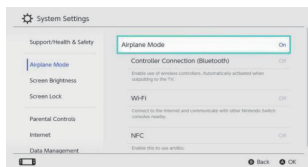

③

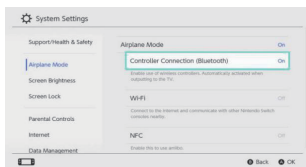

④

Step 2: Enter the Bluetooth pairing mode of the console and controller, click the Controllers menu button on the console homepage interface (Figure ⑤), enter the next menu option and click the Change Grip/Order option. The console will automatically search for paired controllers (Figure ⑥).

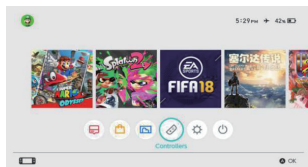

⑤

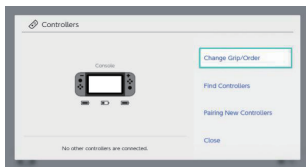

⑥

Step 3: Press and hold the HOME button for 3-5 seconds to enter the Bluetooth search pairing mode, LED1-LED4 marquee flashes quickly. After the controller is successfully connected to the console, it vibrates and automatically assigns the corresponding channel indicator of the controller to be steady on.



⑦

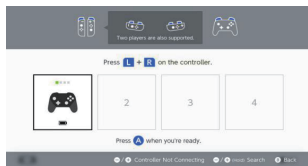

⑧

• Console mode wired connection:

Turn on the wired connection option of the PRO controller on the console, put the console into the console base, and then connect the controller via the data cable, the controller will automatically connect to the console, after the data cable is pulled out, the controller will automatically connect back to the console console via Bluetooth.

• Windows (PC360) mode:

When the controller is turned off, connect to the PC via a USB cable, and the PC will automatically install the driver. The LED2 on the controller is long on to indicate a successful connection.

The display name: Xbox 360 controller for windows .(wired connection)

♥ TURBO Function Setting

- The controller has the TURBO function, hold down the TURBO button and then press the corresponding button to set the TURBO.

In SWITCH mode, A, B, X, Y, L1, R1, L2, R2 can be set

In XINPUT mode, you can set A, B, X, Y, L1, R1, L2, R2

- Adjust Turbo speed:

Turbo + right 3d up, the frequency increases by one gear

Turbo + Right 3d down the frequency by one gear

The power-on default is 12Hz; there are three levels (5 times per second --- 12 times per second --- 20 times per second). When the Turbo combo is executed, the Turbo combo speed LED1 flashes accordingly as the Turbo indicator.

♥ Motor Vibration Function

The controller has a motor function; it uses a pressure-sensitive motor; the console can manually turn on or off the controller motor vibration. ON/OFF

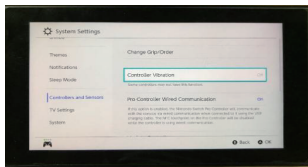
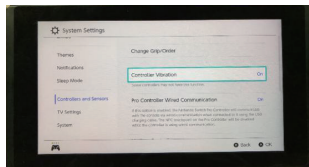

Motor intensity can be adjusted under SWITCH platform

Adjust the motor intensity:

turbo+ left 3d up, the intensity increases by one gear

turbo+ left 3d down, the intensity is reduced by one gear

A total of 4 levels:

100% strength, 70% strength, 30% strength, 0% strength, Power-on default 100%

♥ Frequently Asked Questions

1. The situation where the controller needs to be reset: When there is an abnormality, such as a button disorder, crash, failure to connect, etc., you can try to restart the controller.

2. Unable to connect to the console under abnormal conditions:

A. The channel indicator of the HOME button flashes quickly, please pay attention to whether the 4 LED lights flash fast or slowly. If there is a slow flash or not 4 LED lights flash, you can reset the controller or long press HOME Key to close the controller and reconnect.

B. Please check whether you enter the controller connection page according to the operation, and the console enters the state of Figure ⑦.

C. After the connection is successful, the indicator will be assigned according to the console. The controller at position 1 will keep on with the first light, the controller at position 2 will keep on with the 1.2 light, and so on.

♥ Power off/Charge/Reconnect/Reset/Low Battery Alarm

status	Description
power off	When the controller is turned on, press and hold the HOME button for 5S to turn off the controller.
	When the controller is in the back-connecting state, it will automatically shut down when it cannot be connected after 30 seconds.
	When the controller is in the state of code matching, it will enter back connection when the code cannot be matched after 60 seconds, and it will automatically shut down .
	When the controller is connected to the machine, it will automatically shut down when there is no button operation within 5 minutes .
charge	When the controller is turned off and the controller is inserted into the adapter, LED 1-4 flashes, after fully charged, LED 1-4 goes out.
	The controller is online, when the controller is plugged into the USB, the corresponding channel light flashes slowly, and it lights up when it is full.
Reconnect	The console wakes up and reconnects: After the controller is connected to the console, the console is in sleep state, the controller connection indicator is off, short press the controller HOME button, the indicator light flashes slowly and the marquee flashes back to wake up the console. The console wakes up in about 3-10 seconds on. (The console wake-up state can only be effective by pressing the HOME key)
	Reconnect when the console is powered on: When the console is powered on, press any key on the controller to reconnect (the left and right 3D/L3/R3 cannot be connected back)
reset	When the controller is abnormal, such as button disorder, crash, failure to connect, etc., you can try to restart the controller. Reset method: Insert a slender object into the Reset hole on the back of the controller, and press the Reset button to reset the controller state.

Low battery alarm	When the controller battery voltage is lower than 3.6V (according to the principle of battery characteristics), the light of the corresponding channel flashes slowly, indicating that the controller is low and needs to be charged. 3.45V low power shutdown.
-------------------	---

♥ Precautions

DO NOT use this product near fire sources;

DO NOT place the product in a humid or dusty environment;

DO NOT expose to direct sunlight or high temperature;

DO NOT use chemicals such as gasoline or thinner;

DO NOT hit the product or make it fall due to strong impact;

DO NOT bend or pull the cable parts strongly;

DO NOT disassemble, repair or modify.

♥ Package

1 X Controller

1 X USB Charging Cable

1 X User Instruction

This device complies with Part 15 of the FCC Rules. Operation is subject to the following two conditions: (1) this device may not cause harmful interference, and (2) this device must accept any interference received, including interference that may cause undesired operation

NOTE: This equipment has been tested and found to comply with the limits for a Class B digital device, pursuant to Part 15 of the FCC Rules. These limits are designed to provide reasonable protection against harmful interference in a residential installation. This equipment generates, uses and can radiate radio frequency energy and, if not installed and used in accordance with the instructions, may cause harmful interference to radio communications. However, there is no guarantee that interference will not occur in a particular installation.

If this equipment does cause harmful interference to radio or television reception, which can be determined by turning the equipment off and on, the user is encouraged to try to correct the interference by one or more of the following measures:

- Reorient or relocate the receiving antenna.
- Increase the separation between the equipment and receiver.
- Connect the equipment into an outlet on a circuit different from that to which the receiver is connected.
- Consult the dealer or an experienced radio/TV technician for help.

Warning: changes or modifications not expressly approved by the party responsible for compliance could void the user's authority to operate the equipment